

TRU-DOOR™ Piggy Back Door Systems

Description

TRU-DOOR™ Piggy Back Door Systems

Product Information

This unique Tru-Door™ Piggy Back Door System by Tru-Bilt Industries provides the ability to operate two doors in one opening space. Now you can use a Tru-Sprint™ Rapid Roll Door for quick access, clear visibility and superb environmental control during operating hours, while ensuring overnight protection and full security with the Tru-Roll™ Roller Shutter Door at the end of the day. Convenience and security in one.

Technical Specification

- ✓ Tru-Door™ Piggy Back bracket set for mounting a Tru-Sprint™ Rapid Roll Door to the Tru-Roll™ Roller Shutter Door
- ✓ Enables roller shutter door to be fitted to the wall, Z angle brackets to be fitted over the top and rapid doors mounted onto these. (The roller shutter tracks can be removed if necessary)
- ✓ Brackets can be used in both Z Angle and C Channel configurations
- ✓ No extra flashings required on sides of door openings

Three size variations available according to door opening height:

- ✓ Doors up to 4.2m DOH = 4 x 2400mm long 3mm Mild Steel Zinc Plated Continual Wall Angle Brackets to suit door height
- ✓ Doors from 4.3m to 5.4m DOH - 5 x 2400mm long 3mm Mild Steel Zinc Plated Continual Wall Angle Brackets to suit door height
- ✓ Doors from 5.5m to 6.6m DOH - 6 x 2400mm long 3mm Mild Steel Zinc Plated Continual Wall Angle Brackets to suit door height

Clearance Details

Headroom = 600mm

Sideroom = 250mm

Sideroom on motor side = 400mm

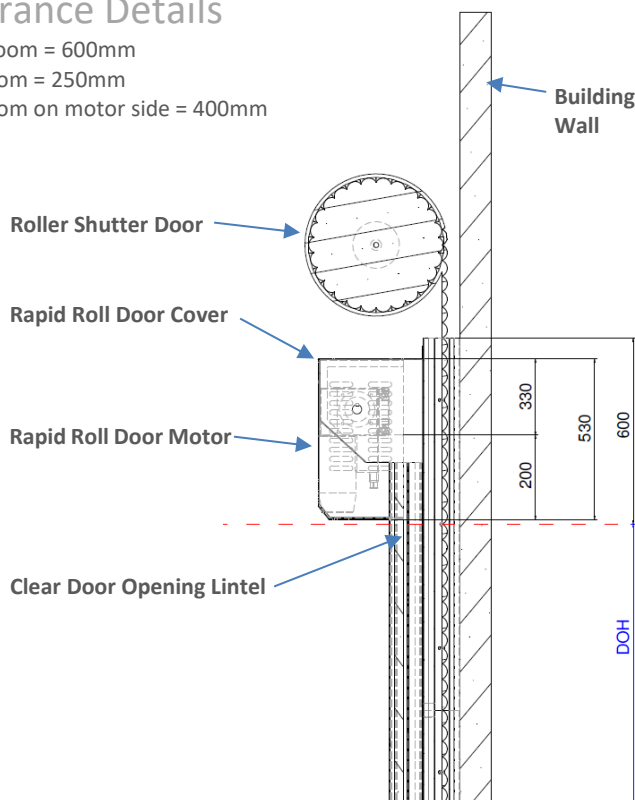

Need more information? Contact us today – NZ 0800-144-999, AU 1800-144-888 or visit www.tru-bilt.co.nz



C Track Style

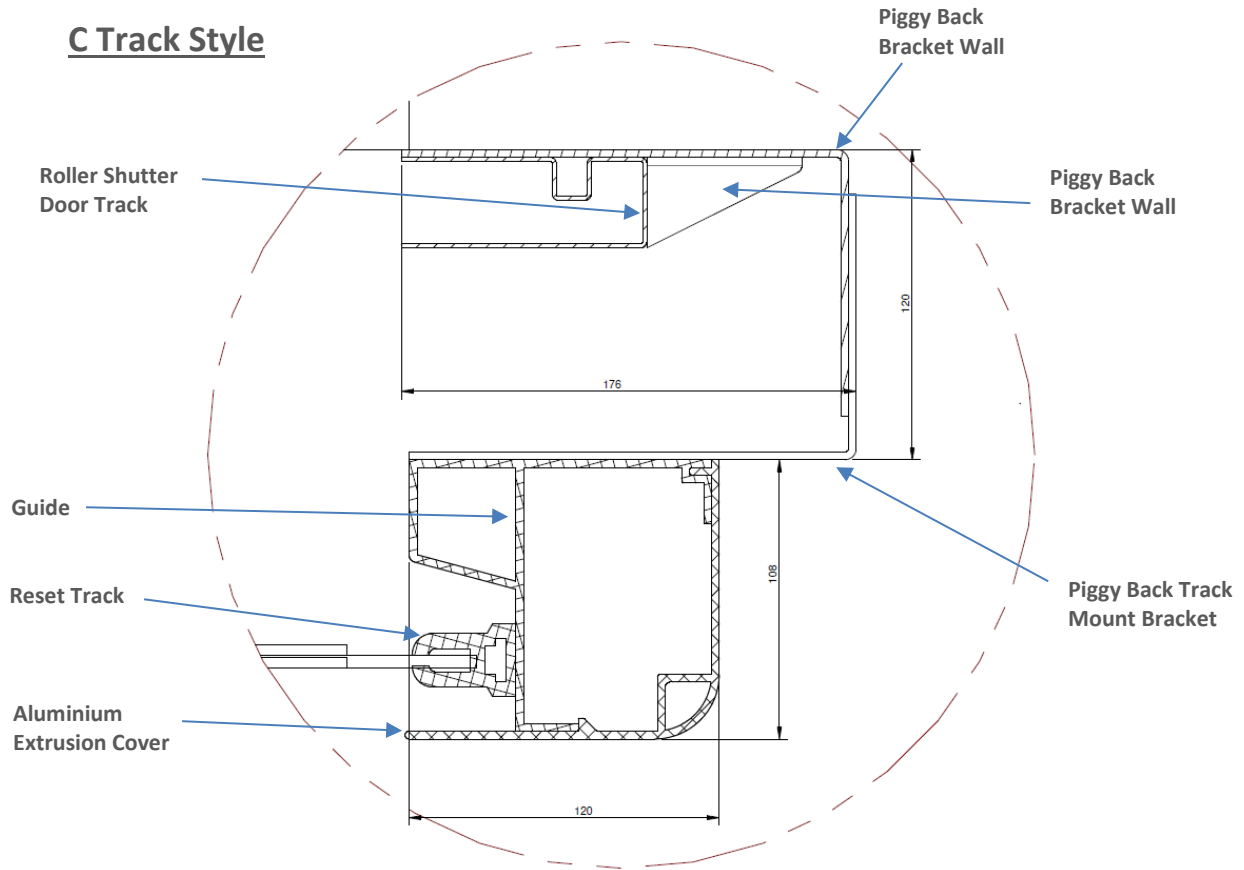

Z Track Style

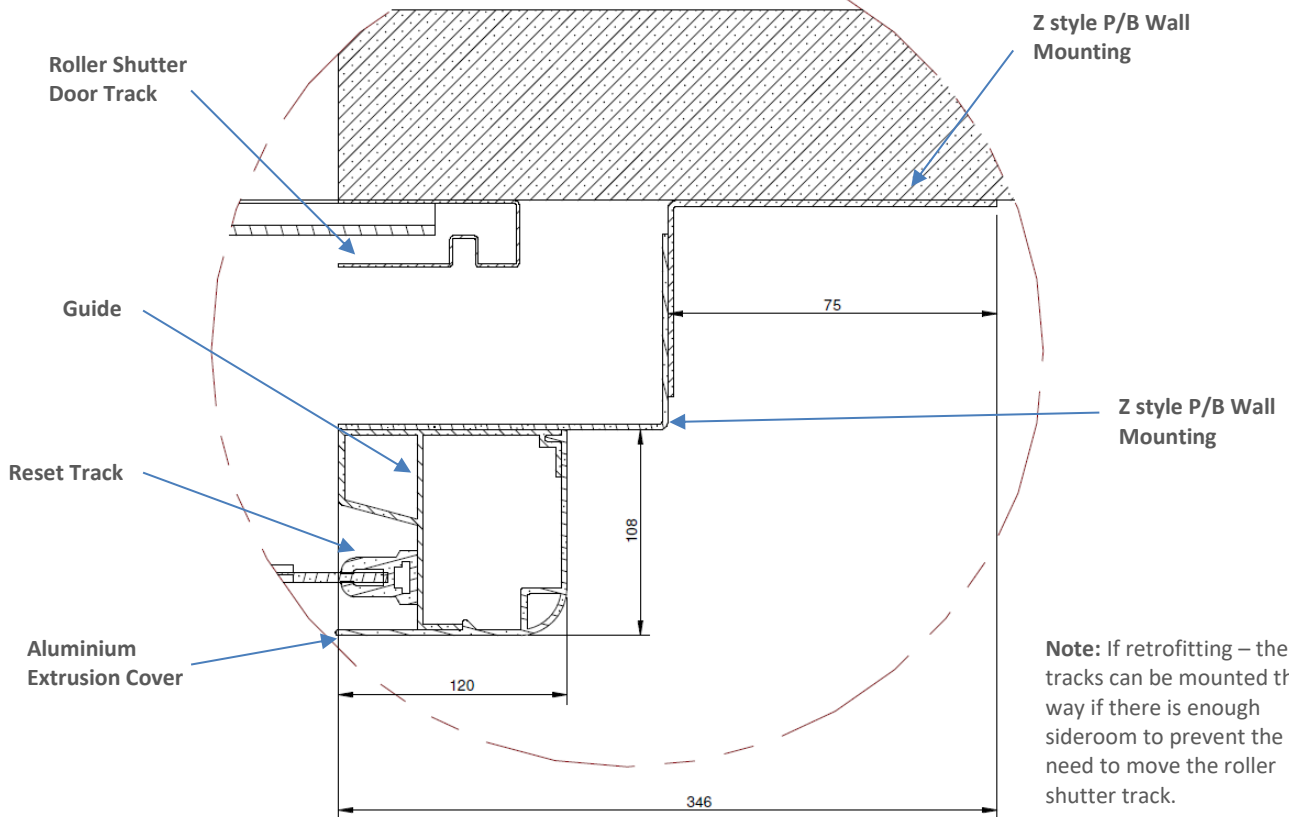

Note: If retrofitting – the tracks can be mounted this way if there is enough sideroom to prevent the need to move the roller shutter track.

Need more information? Contact us today – NZ 0800-144-999, AU 1800-144-888 or visit www.tru-bilt.co.nz

