

TRU-VIEW

INDUSTRIAL SECTIONAL DOOR

ENQUIRY FORM

Download form to PC before editing

Site Details

Company Name:		Date:
Delivery Address:		
Customer Reference/Order Number:		
Contact Name:	Phone:	
Site Photos Provided: Yes <input type="checkbox"/> No <input type="checkbox"/>	Completed By:	

Door Information (see TRU-VIEW Data Sheet for full specification details)

- On the drawing below, enter the door opening measurements (height and width), as well as the headroom and sideroom measurements. Enter the backspace depth if applicable.**

(NB: Recommended maximum door size: 5000mmH x 5600mmW. (The Maximum width for IL4 rating is 4250mmW). Minimum sideroom on motor side 300mm, on non-motor side 175mm. See Track Configuration table overleaf for details on minimum headroom and backspace).

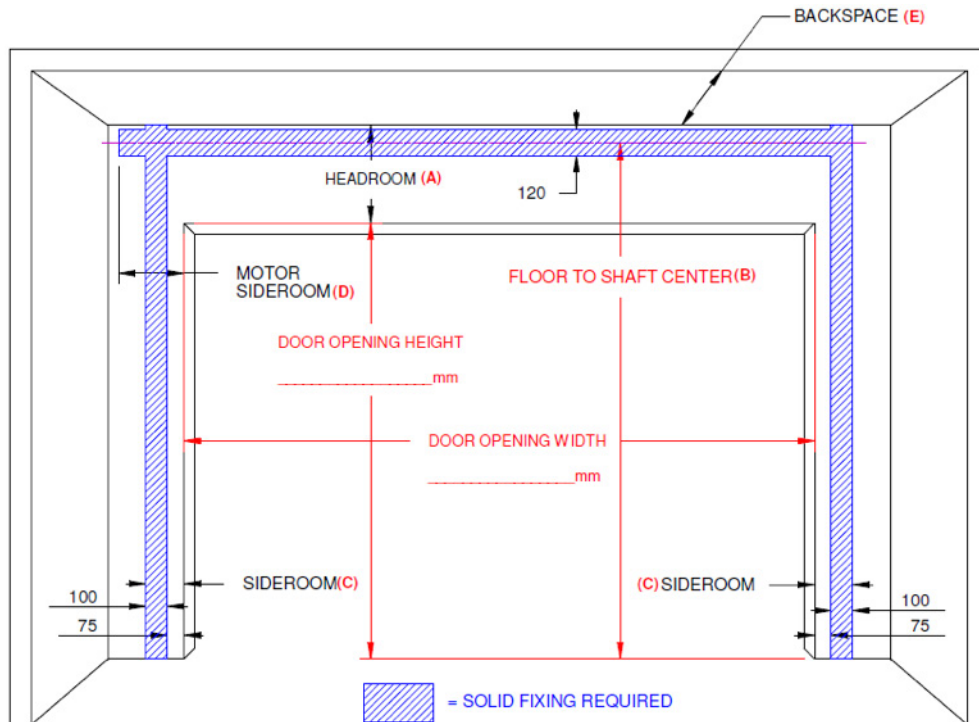

- Quantity** of doors required at this size and specification:

Continued over page...

3) **Operating Environment:** Temperature: °C
 Wind speed: km/h Pressure: Bar

4) **Wall Construction:**

Thickness: mm

5) **Door Panel options:**

TRU-VIEW™ Panels – maximum panel height 500mmH

TRU-VIEW™ Panel Infill:

- ACM board;** Colours available:
- | | |
|--|--|
| <input type="checkbox"/> White Gloss | <input type="checkbox"/> Black – <input type="checkbox"/> Gloss <input type="checkbox"/> Satin |
| <input type="checkbox"/> Blue – <input type="checkbox"/> Light <input type="checkbox"/> Dark | <input type="checkbox"/> Red – <input type="checkbox"/> Light <input type="checkbox"/> Dark |
| <input type="checkbox"/> Yellow – <input type="checkbox"/> Light <input type="checkbox"/> Dark | <input type="checkbox"/> Green – <input type="checkbox"/> Light <input type="checkbox"/> Dark |
| <input type="checkbox"/> Orange | <input type="checkbox"/> Silver – <input type="checkbox"/> Matt <input type="checkbox"/> Brushed |

Glass; Safety Laminated Clear Light Grey Tint

Acrylic; Clear Light Grey Tint

Calculate the number of panels required based on maximum 500mm panel height.

Mark your panel layout in the box to the right, indicating your infill choices in the preferred position.

For example:

ACM
ACM
ACM
Safety Glass
Safety Glass
ACM
ACM

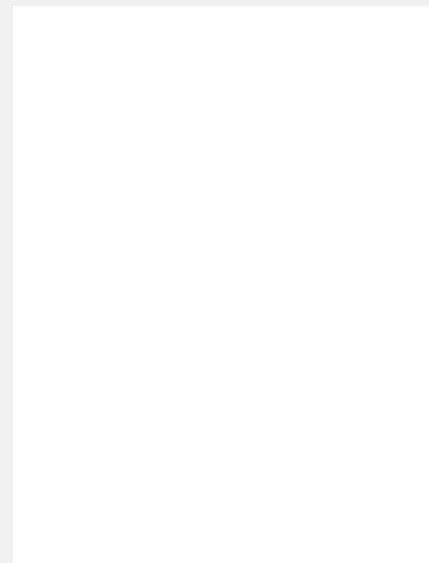

NB: Aluminium frames are silver anodised as standard. Frames can be powder coated at extra cost.

Powder coating required. Colour:

6) **Door Automation options:** (NB: Hand chain or motor must be chosen)

Manual Hand Chain

OR;

Motorised. Type of motor: DOD14-PS DD1 DO IT MS110

Which side? LH RH (Door mounting side)

Continued over page...

